

SITE PLAN

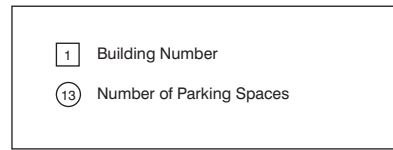
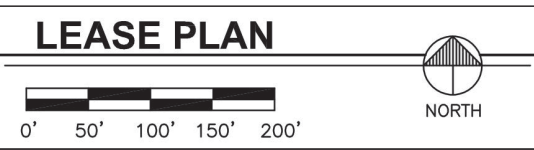
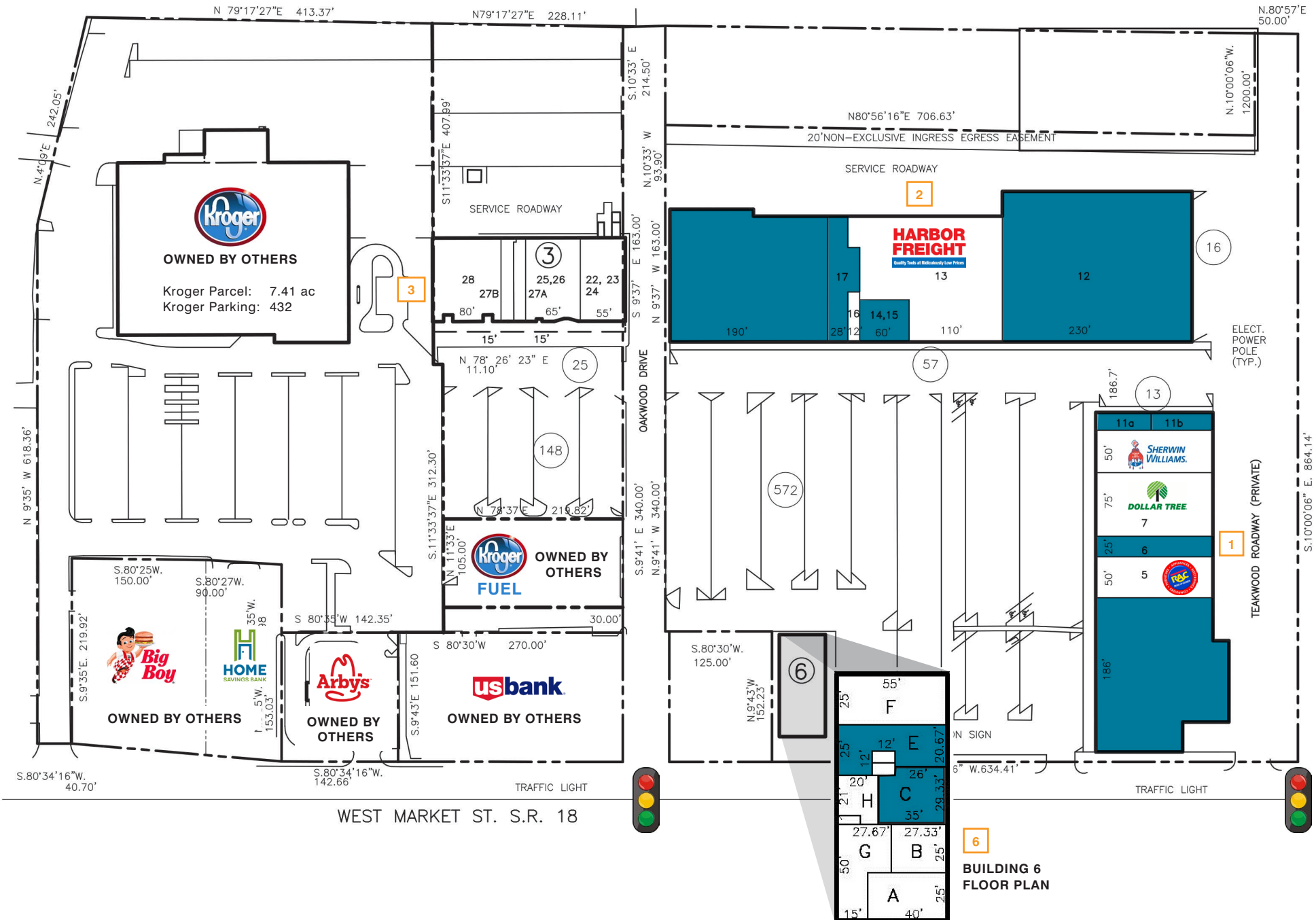

Latitude: 41.11288 Longitude: -83.20774

TENANT INFORMATION

UNIT #	STREET #	%	LEASABLE SQ. FT.	DIMENSIONS	LESSEE
BUILDING #1					
1	646	14.21	26,943	(186x101)+(60.33x101.33)+(40.33x50.67)	Available
5	654	3.73	7,067	50x141.33	Rent-A-Center
6	656	1.86	3,533	25x141.33	Available
7	658	5.59	10,600	75x141.33	Dollar Tree
10	664	3.73	7,067	50x141.33	Sherwin-Williams
11A	666	0.65	1,238	18.67x66.33	Available
11B	668	0.74	1,400	18.67x75	Available
TOTAL:		30.51	57,848		

BUILDING #2					
12	680	21.36	40,480	230x176	Available
13	682	12.29	23,296	(110x151.33)+(60x101.33)+(15x38)	Harbor Freight Tools
14	686	1.58	3,000	60x50	Available
16	690	0.38	720	12x60	Westgate Barber
17	692	2.51	4,763	(28x113.33)+(12x53.33) + (25x38)	Available
18	710	15.63	29,631	(190x151.33)+(8.67x101.33)	Available
TOTAL:		53.75	101,890		

BUILDING #3					
22	738	2.90	5,500	55x100	T.J. Willies
25	746	3.43	6,500	65x100	Shoe Sensation
27A	748-A	0.79	1,483	15x100-(3.33x5)	Sally Beauty
27B	748-B	0.79	1,517	15x100+(3.33x5)	Supercuts
28	750	4.22	8,000	80x100	Crane's Mattress
TOTAL:		12.13	23,000		

BUILDING #6					
A	716-A	0.53	1,000	25x40	Advanced Chiropractic
B	716-B	0.36	683	25x27.33	Professional Hearing
C	716-C	0.56	1,060	(29.33x33.35)+0.5(12x12)-(4.33x9)	Available
E	716-E	0.63	1,190	(25x55)-0.5(12x12)-(4.33x26)	Available
F	716-F	0.73	1,375	25x55	Head Shed
G	716-G	0.56	1,067	(50x27.67)-(25x12.67)	Advanced Chiropractic
H	716-H	0.24	453	(21x20)+(4x8.33)	Advanced Chiropractic
I	716-I	Excl'd	Excl'd	11.67x4	LL Area/Elec.Room
TOTAL:		3.61	6,828		

TOTAL FOR CENTER:	100.00	189,566
--------------------------	--------	---------

Site Area: 16.28 ac Greenspace: 0.32 ac □ Denotes building number
 Pavement Area: 11.52 ac Total Parking: 878
 Building Area: 193,613 sf

All aspects of the above lease plan, including access points, dimensions, addresses, trade names, etc. are believed to be accurate but remain subject to change at any time without notice.